

Hotham 230

4  2  2 

HOUSE LAND DRIVEWAY FENCING LANDSCAPING JUST MOVE IN
house & land package from \$464,300*

\$464,300* on lot 653 (599sqm)



All packages expire 30/4/10

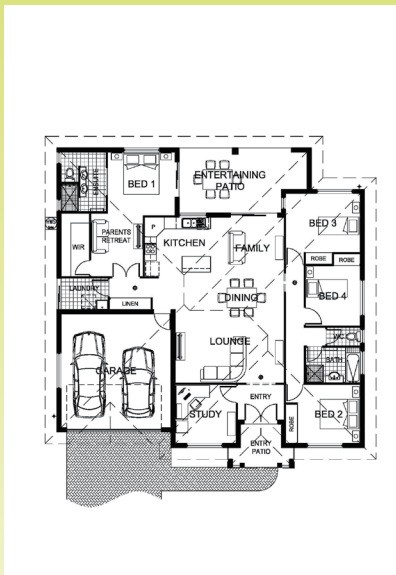

- Master with ensuite, WIR & parents retreat
- Open Plan Kitchen/Dining
- Entertaining Patio

Inclusions

All external walls rendered and painted
2.5 metre high ceilings
Roof Insulation
Solar Hot Water System
Colourbond Roof
Panel lift double garage door, auto
Designer kitchen, vanities
Rangehood, underbench oven and cooktop.
Built-ins to bedrooms
Built-in linen cupboard
Tiles to living, porch, patio and wet areas.
Carpet to bedrooms
Air-conditioning to all bedrooms

Living Areas	169.18 sqm
Patio	26.13 sqm
Garage	34.80 sqm
TOTAL AREA	230.11 sqm

Ceiling fans to all rooms
Exhaust fans
Security screens to windows & doors
TV antenna
Rendered Letterbox
Clothesline
Exposed aggregate driveway
Fencing
Landscaping Allowance
Turf and irrigation

Sales and Info Ph: 4723 8933

www.kalyndachase.com.au

urbex *designed for life*



kalynda
chase
connecting quality of life

* House and land packages are priced with standard inclusions. Home and land sold separately. Urbex is responsible for the sale of the land only. Purchasers will need to enter into a separate contract with the relevant builder for the construction of the home. Photographs and illustrations are intended to be a visual aid only and do not necessarily depict the actual development of the home. Urbex gives no warranty and makes no representation as to the accuracy or sufficiency of any description, photography, illustration or statement contained in this brochure and accepts no liability for any loss which may be suffered by any person who relies wholly or in part upon the information presented. All information provided is subject to change without notice. Final designs will be subject to the purchasers obtaining building design covenant approval pursuant to the provisions of the Kalynda Chase Housing Design Guidelines.