



**WATER LEGEND**

- WATER MAIN
- - - 63 OD POLYETHYLENE LOOP MAIN
- FH FIRE HYDRANT
- SV SLUICE VALVE
- GV GATE VALVE
- TEE
- END CAP
- WATER SERVICE WITH ENVELOPER
- EXIST. WATER MAIN
- EXIST. WATER MAIN (POLY)

**WATER NOTES**

1. ALL WATER MAINS ARE LOCATED 1.2m ALIGNMENT OFFSET FROM PROPERTY BOUNDARIES UNLESS SHOWN OTHERWISE
2. THIS DRAWING IS TO BE READ IN CONJUNCTION WITH TOWNSVILLE CITY COUNCIL STANDARD DRAWINGS (WATER).
3. ALL UPVC MAINS ARE SERIES 2, PN16 TO AS/NZS 1477 RUBBER RING JOINTED, WITH SOCKETED D.I.C.L. FITTINGS U.N.O.

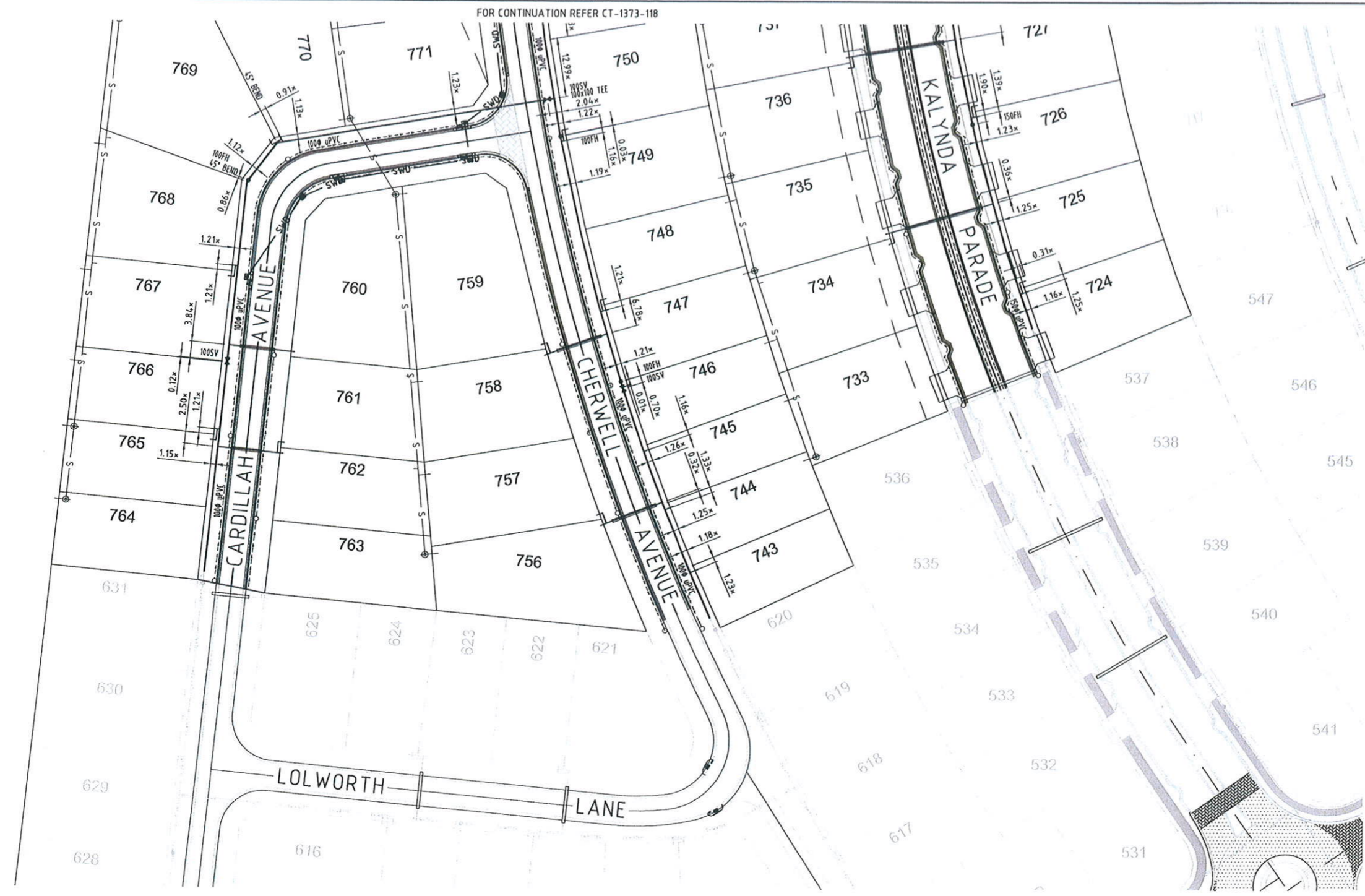

BRAZIER MOTTI PTY LTD. ACN 066 411 041  
 595 FLINDERS ST. TOWNSVILLE, HEREBY CERTIFY THAT  
 THIS DRAWING ACCURATELY AND CORRECTLY DESCRIBES  
 AND RECORDS THE NATURE AND LOCATION OF THE WORKS  
 DEPICTED BY ASTERISKS (\*) HEREON AS THEY HAVE BEEN  
 CONSTRUCTED FOR SUBDIVISION.

*[Signature]*  
 DIRECTOR  
 LICENSED SURVEYOR & DIRECTOR

Dated This 19th day of Aug. 2010

**PROPERTY DESCRIPTION**

LOT 2 ON RP739629

**DATUM**  
 PM No.131651 LOCATED ON  
 HERVEY RANGE ROAD (BOLT IN BITUMEN)  
 RL 19.248m AHD

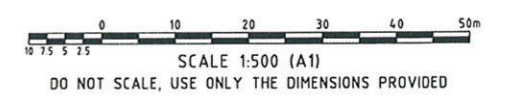

User: STATION JACOBS@BMD Date: 19/08/2010 10:44:38 AM  
 User: STATION JACOBS@BMD Name: AUCT-1300 - KALYNDA CHASE - Stage 8 Drawings\As Con\CT-1373-410

No.	Amendments	By	Appd	Date	No.	Amendments	By	Appd	Date
A	AS CONSTRUCTED	S.J.J.	[Signature]	19.08.10					



**BMD CONSULTING**  
 Civil Engineers  
 Structural Engineers  
 & Project Managers

Head Office - Brisbane Ph: (07) 3893 7000  
 25 Cambridge Parade, Mt Abu Ph: (07) 3893 4083  
 P.O. Box 197 email: bmdcons@bmd.com.au  
 WYNNUH, QLD 4178 www.bmd.com.au

Sydney Office Ph: (02) 9898 5400  
 Townsville Office Cairns Office  
 Ph: (07) 4750 7000 Ph: (07) 4035 1515

Design	S.J.J.
Drawn	W.E.S.
Checked	W.E.S.
Original Approved By:	[Signature]
RPEQ No.	5948
Date	AUG '10
Datum	A.H.D.

Client	<b>URBEX PTY. LTD.</b>		
Project	<b>KALYNDA CHASE STAGE 8</b>		
Title	<b>WATER RETICULATION LAYOUT PLAN (SHEET 1 OF 2)</b>		
	AS CONSTRUCTED	Drawing No.	CT-1373-117
		Rev	A

THIS DRAWING CANNOT BE COPIED OR REPRODUCED IN ANY FORM OR USED FOR ANY OTHER PURPOSE OTHER THAN THAT ORIGINALLY INTENDED WITHOUT THE WRITTEN PERMISSION OF BMD CONSULTING PTY LTD.



**WATER LEGEND**

- WATER MAIN
- - - 63 OD POLYETHYLENE LOOP MAIN
- FH FIRE HYDRANT
- SV SLUICE VALVE
- GV GATE VALVE
- TEE
- END CAP
- WATER SERVICE WITH ENVELOPER
- - - EXIST. WATER MAIN
- - - EXIST. WATER MAIN (POLY)

**WATER NOTES**

1. ALL WATER MAINS ARE LOCATED 1.2m ALIGNMENT OFFSET FROM PROPERTY BOUNDARIES UNLESS SHOWN OTHERWISE
2. THIS DRAWING IS TO BE READ IN CONJUNCTION WITH TOWNVILLE CITY COUNCIL STANDARD DRAWINGS (WATER).
3. ALL uPVC MAINS ARE SERIES 2, PN16 TO AS/NZS 1477 RUBBER RING JOINTED, WITH SOCKETED D.I.C.L. FITTINGS U.N.O.

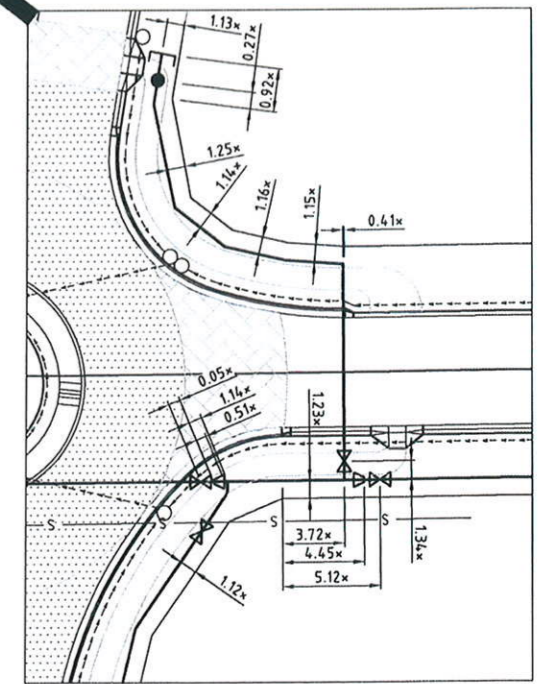
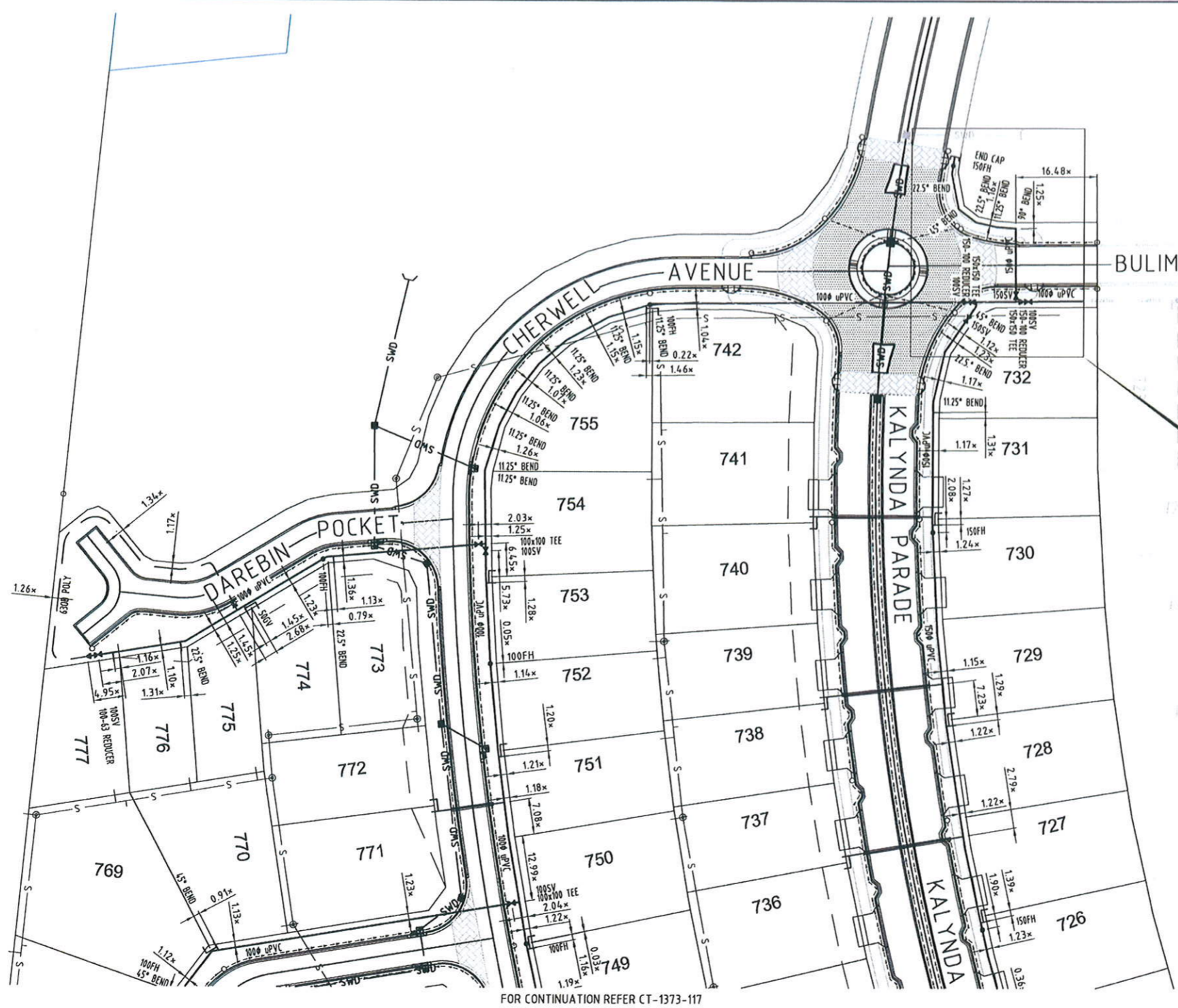

**INSET 'A'**  
1:250 @ A1

BRAZIER MOTTI PTY LTD. ACN 066 411 041  
595 FLINDERS ST. TOWNVILLE, HEREBY CERTIFY THAT THIS DRAWING ACCURATELY AND CORRECTLY DESCRIBES AND RECORDS THE NATURE AND LOCATION OF THE WORKS DEPICTED BY ASTERISKS (\*) HEREON AS THEY HAVE BEEN CONSTRUCTED FOR SUBDIVISION.

*[Signature]*  
DIRECTOR  
LICENSED SURVEYOR & DIRECTOR

Dated This 19 day of Aug 2010

**PROPERTY DESCRIPTION**

LOT 2 ON RP739629  
**DATUM**  
PM No. 131651 LOCATED ON  
HERVEY RANGE ROAD (BOLT IN BITUMEN)  
RL 19.248m AHD

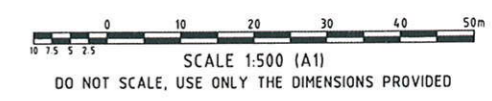

No.	Amendments	By	Appd	Date	No.	Amendments	By	Appd	Date
A	AS CONSTRUCTED	S.J.J.	[Signature]	19.08.10					



**BMD CONSULTING**  
Civil Engineers  
Structural Engineers  
& Project Managers  
ASB 23 010 143 602

Head Office - Brisbane Ph: (07) 3893 7000  
25 Cambridge Parade, Mt Sggs Ph: (07) 3893 4088  
P.O. Box 197 email: bmd@bmd.com.au  
WYNNUM, QLD 4178 www.bmd.com.au

Sydney Office Ph: (02) 9898 5400  
Townsville Office Ph: (07) 4750 7000  
Cairns Office Ph: (07) 4035 1511

Design	—
Drawn	S.J.J.
Checked	W.E.S.
Original Approved By:	[Signature]
RPEQ No.	5948
Date	AUG '10
Datum	A.H.D.

Client	<b>URBEX PTY. LTD.</b>	
Project	<b>KALYNDA CHASE STAGE 8</b>	
Title	<b>WATER RETICULATION LAYOUT PLAN</b>	<b>AS CONSTRUCTED</b>
	<b>(SHEET 2 OF 2)</b>	Drawing No. <b>CT-1373-118</b>
		Rev <b>A</b>

Plot Date: 19/08/2010 10:44:45 AM User: STRAITON JACOBS@bmd.com.au Stage: P1000001.ctb Path: C:\Users\straiton\Documents\Projects\1373-118\1373-118.dwg

THIS DRAWING CANNOT BE COPIED OR REPRODUCED IN ANY FORM OR USED FOR ANY OTHER PURPOSE OTHER THAN THAT ORIGINALLY INTENDED WITHOUT THE WRITTEN PERMISSION OF BMD CONSULTING PTY LTD.