

SEWERAGE LEGEND

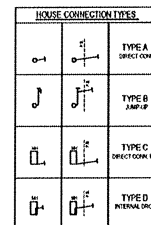
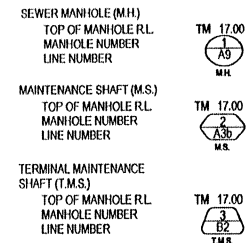
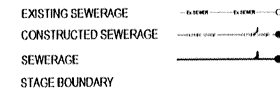

SEWERAGE NOTES

1. ALL LINES LESS THAN 5.7m DEEP ARE 100MM DIAMETER PVCU DWV S10 IN ACCORDANCE WITH STANDARD AS/NZS 1260:1999. UNLESS SHOWN OTHERWISE.
2. ALL 100mm DIAMETER SEWER LINES LESS THAN 5.7m DEEP ARE PVCU DWV S10 IN ACCORDANCE WITH STANDARD AS/NZS 1260:1999. UNLESS SHOWN OTHERWISE.
3. EACH ALLOTMENT SERVED BY A 100MM PROPERTY CONNECTION.
4. O.S.S LOCATED 1.5m FROM CONSTREAM ALIGNMENT.
5. PROPERTY CONNECTION BRANCHES EXTEND INTO THE PROPERTY A MINIMUM OF 1.0m.
6. PROPERTY CONNECTIONS CROSSING U/G ELECTRICITY ALLOCATION HAVE A MINIMUM OF 1.0m COVER.
7. TOP OF MANHOLES ARE 150mm ABOVE F.S.L. AS PER C.O.T. STANDARD DWGS.
8. BACKFILL ROAD CROSSINGS WITH CRUSHER DUST COMPACTED TO NOT LESS THAN 95% OF THE STANDARD MAX. DRY DENSITY TO A.S. 1289, INCLUDING FUTURE ROAD CROSSINGS.
9. SEWER MANHOLES ARE LOCATED 1.5m FROM THE PROPERTY BOUNDARIES U.N.O.
10. * DEPICTS AS CONSTRUCTED DATA

BRADNER NOTHI PTY LTD. ACN 868 411 843
 585 FLINDERS ST., FORTMERRILE, HERBERTY CERTIFY THAT
 THIS DRAWING ACCURATELY AND CORRECTLY DESCRIBES AND
 RECORDS THE NATURE AND LOCATION OF THE WORKS
 DEPICTED BY ASSURING THAT PERSON AS THEY HAVE BEEN
 CONSTRUCTED TO DATE 15/07/2010

DATUM
 PM No.131651 LOCATED ON
 HERVEY RANGE ROAD (BOLT IN BITUMEN)
 RL 19.248

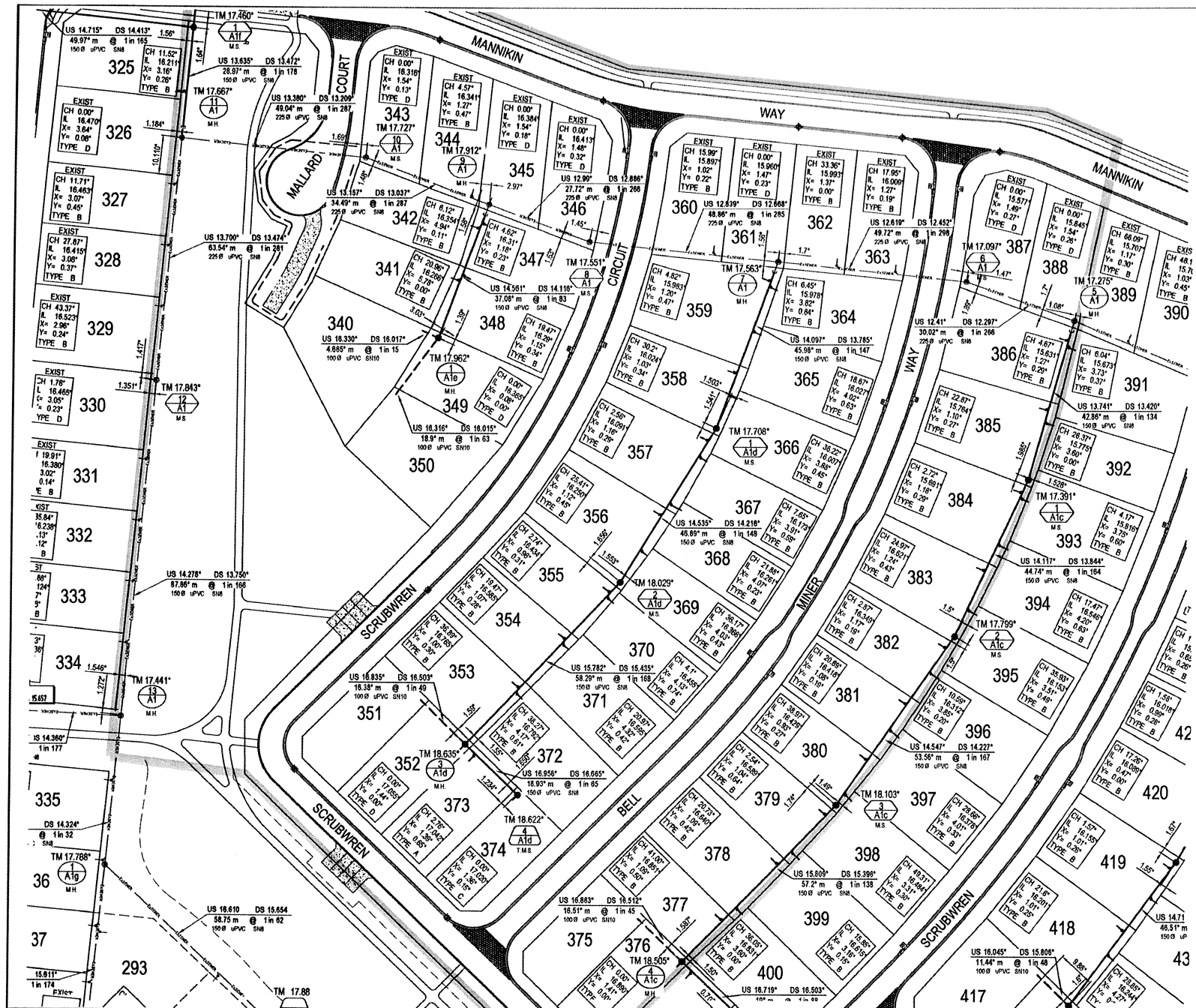
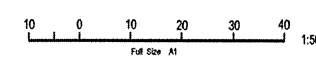

No.	Amendments	By	Appd	Date	No.	Amendments	By	Appd	Date
B	AMENDED AS PER COT LETTER 28.07.07	S.J.J		24.08.07					
A	ORIGINAL ISSUE	S.J.J		09.07.07					

BMD CONSULTING
 Civil Engineers
 Structural Engineers
 Project Managers
 ABN 23101743592

Urbex Office
 97 Unshill Drive,
 Toowoomba QLD 4300
 P.O. Box 8008
 Toowoomba QLD 4300
 Tel: (07) 4780 7000
 Fax: (07) 4780 7001
 Email: info@bmd.com.au
 www.bmd.com.au

Head Office - Brisbane
 P.O. Box 11111
 Sturges Quay
 Brisbane QLD 4000
 Tel: (07) 4936 1111
 Fax: (07) 4936 1144
 Email: info@bmd.com.au
 www.bmd.com.au

URBEX Pty Ltd
 Client
KALYNDA CHASE - STAGE 4B
 Project
SEWERAGE RETICULATION LAYOUT PLAN
 Title
AS CONSTRUCTED
 Drawing No. **CT-1173-401**
 Rev **B**

Design: S.J.J.
 Drawn: W.E.B.
 Checked: W.E.B.
 Original Approved By: [Signature]
 RPEQ No: 5948
 Date: JULY 07
 Datum: A.M.D.

THIS DRAWING CANNOT BE COPIED OR REPRODUCED IN ANY FORM OR USED FOR ANY OTHER PURPOSE OTHER THAN THAT ORIGINALLY INTENDED WITHOUT THE WRITTEN PERMISSION OF BMD CONSULTING PTY LTD.